

Corrosion protection through
surface hot dip galvanization

Robust and reliable

Compact and manoeuvrable

Unique controls



AM G20

Electro-plated hand pallet truck (2,000 kg)

The Jungheinrich AM G20 hand pallet truck is the perfect solution for outdoor operation and in particular humid

environments. A zinc coating provides the truck's steel components with a reliable protection against corrosion. The

main application areas include wholesale markets and fruit growing operations.

AM G20

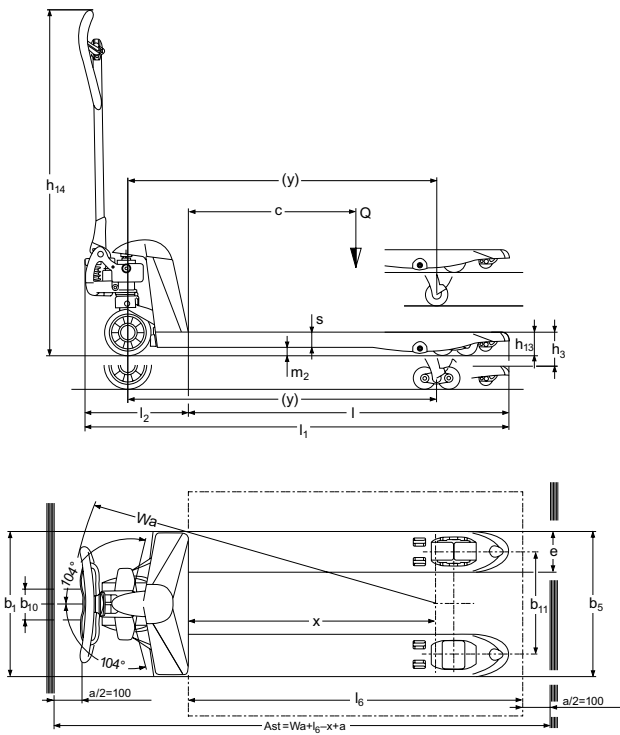

Technical data in line with VDI 2198

Identification	1.1	Manufacturer (short form)		Jungheinrich		
	1.2	Model		AM G20		
	1.3	Drive		manual		
	1.4	Manual, pedestrian, stand-on, seated, order picker operation		hand		
	1.5	Load capacity/rated load	Q t	2		
	1.6	Load centre distance	c mm	400	500	600
	1.8	Load distance	x mm	535	690	890
	1.9	Wheelbase	y mm	755	910	1110
Weights	2.1	Service weight	kg	51 ¹⁾	54 ¹⁾	61 ¹⁾
	2.3	Axle load, w.o. load, front / rear	kg			38 / 20 ³⁾
Wheels / chassis	3.1	Tyres		V;N		
	3.2	Tyre size, at front	mm	Ø 170x50		
	3.3	Tyre size, at rear	mm	Ø 82x96 ⁴⁾		
	3.5	Wheels, number front/rear (x = driven wheels)		2/2 or 2/4		
	3.6	Track width, front	b ₁₀ mm	109		
	3.7	Track width, rear	b ₁₁ mm	370		
Basic dimensions	4.4	Lift	h ₃ mm	122		
	4.9	Height of tiller in drive position min. / max.	h ₁₄ mm	1234		
	4.14	Standing height raised	h ₁₂ mm	205		
	4.15	Lowered height	h ₁₃ mm	83		
	4.19	Overall length	l ₁ mm	1165	1320	1520
	4.20	Length incl. back of forks	l ₂ mm	373		
	4.21	Total width	b ₁ /b ₂ mm	520 ²⁾		
	4.22	Fork dimensions	s/e/l mm	53 / 150 / 795	53 / 150 / 950	53 / 150 / 1150
	4.25	Width over forks	b ₅ mm	520 ²⁾		
	4.32	Floor clearance centre wheelbase	m ₂ mm	30		
	4.33	Aisle width for pallets 1000 x 1200 sideways	Ast mm	1584	1584	1734
	4.34	Aisle width for pallets 800 x 1200 lengthways	Ast mm	1784		
Performance data	4.35	Turning radius	W _a mm	919	1074	1274
	5.3	Lower speed, w. / w.o. load	m/s	0.09 / 0.02		

¹⁾ + 5 kg at 680 mm width across forks

²⁾ 680 mm also possible

³⁾ Width 520 mm

⁴⁾ Ø 82x62 mm tandem tyres

Benefit from the advantages



AM G20 - corrosion protection through galvanisation



Maintenance-free hydraulics



Permanently lubricated joints for maintenance-free operation



Contoured fork tips for easy pallet entry

Galvanised surface

High level of corrosion protection offered by surface hot dip galvanisation.

Easy to operate

The easy to operate control handle is suitable for both left and right-handers. The special lowering valve enables loads to be lowered precisely.

More compact and manoeuvrable

The chassis length of 373 mm allows the truck to be used safely and easily in confined areas.

Effortless and simple

The further optimised hydraulic system reduces the pumping action required. The bushes on the wheels reduce the required drawbar pull.

Quiet and robust

The chromed bushes on the wheels and joints ensure quiet running and an exceptionally long service life. Joints no longer require lubrication; the AM G20 still runs smoothly.

Clear and safe

Markings on the truck show the exact pallet position required for crossways lifting.

Durable

The best guarantees for maximum stability and durability:

- More stable forks.
- Contoured shapes.
- Welded tiller mounting.
- Protected entry rollers.
- High Quality Hardened steel.
- 2000 kg capacity for the basic model.

Optional equipment

The AM G20 can be equipped for any application thanks to an extensive range of optional equipment. This includes a range of fork lengths, various widths, wheel combinations and brake systems.

Jungheinrich UK Ltd.

Head Office:
Sherbourne House
Sherbourne Drive
Tilbrook
Milton Keynes MK7 8HX
Telephone 01908 363100
Fax 01908 363180

info@jungheinrich.co.uk
www.jungheinrich.co.uk

The German production facilities in Norderstedt and Moosburg are certified. **ISO 9001**
ISO 14001

Jungheinrich fork lift trucks meet European safety requirements.



JUNGHEINRICH
Machines. Ideas. Solutions.